

TWO MEETING ROOMS, AV OR SPEAKER FOCUS -  
COMMUNITY OR CORPORATE - 200/150

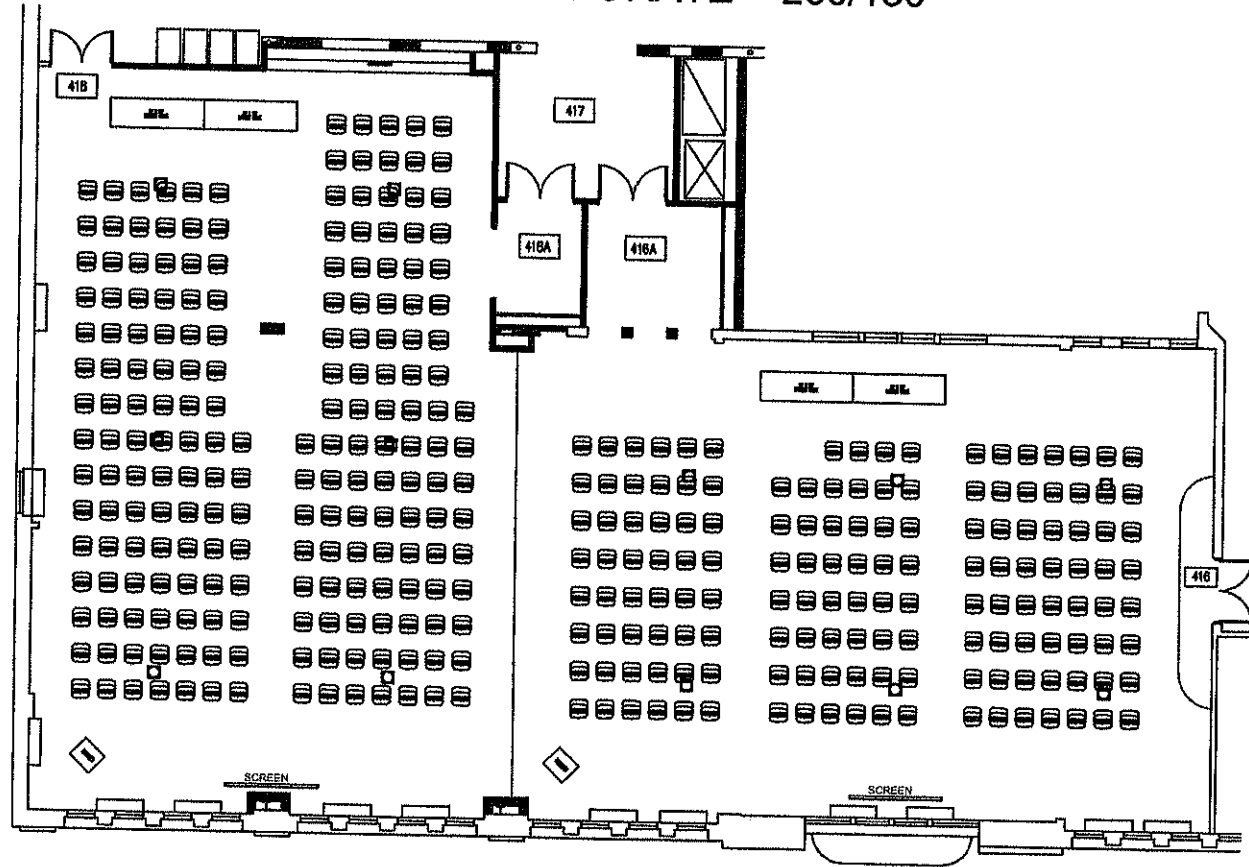

TOTAL OF 17 1/2" W X 19 3/4" D CHAIRS: 200

TOTAL OF 17 1/2" W X 19 3/4" D CHAIRS: 150

TOTAL OF 30" X 96" BANQUET TABLES: 2

TOTAL OF 30" X 96" BANQUET TABLES: 2

APPROVED BY: \_\_\_\_\_

elements **IV**  
interiors

3680 Wyse Road, Dayton, OH. 45414  
(937) 918-1000 / Fax (937) 918-1001

88 CEG/CECH, Building 57 Area B  
2130 Monahan Way, WPAFB, OH. 45433  
(937) 252-3982 / Fax (937) 252-5091

www.elementslv.com

ORR-STATLER  
HOTEL RENOVATION

PROPOSAL #: PIQUA01

SCALE: 1/16" = 1'-0"

DATE DRAWN: 3/13/08

DRAWN BY: ANNE SEWELL

SALES PERSON/PROJECT MANAGER: TARA HUCKE

REVISIONS

NO. 1	3/19/08
NO. 2	4/10/08
NO. 3	4/14/08
NO. 4	
NO. 5	

# TWO BALLROOMS FOR EVENT WITH SPEAKER OR SOCIAL - 144/144

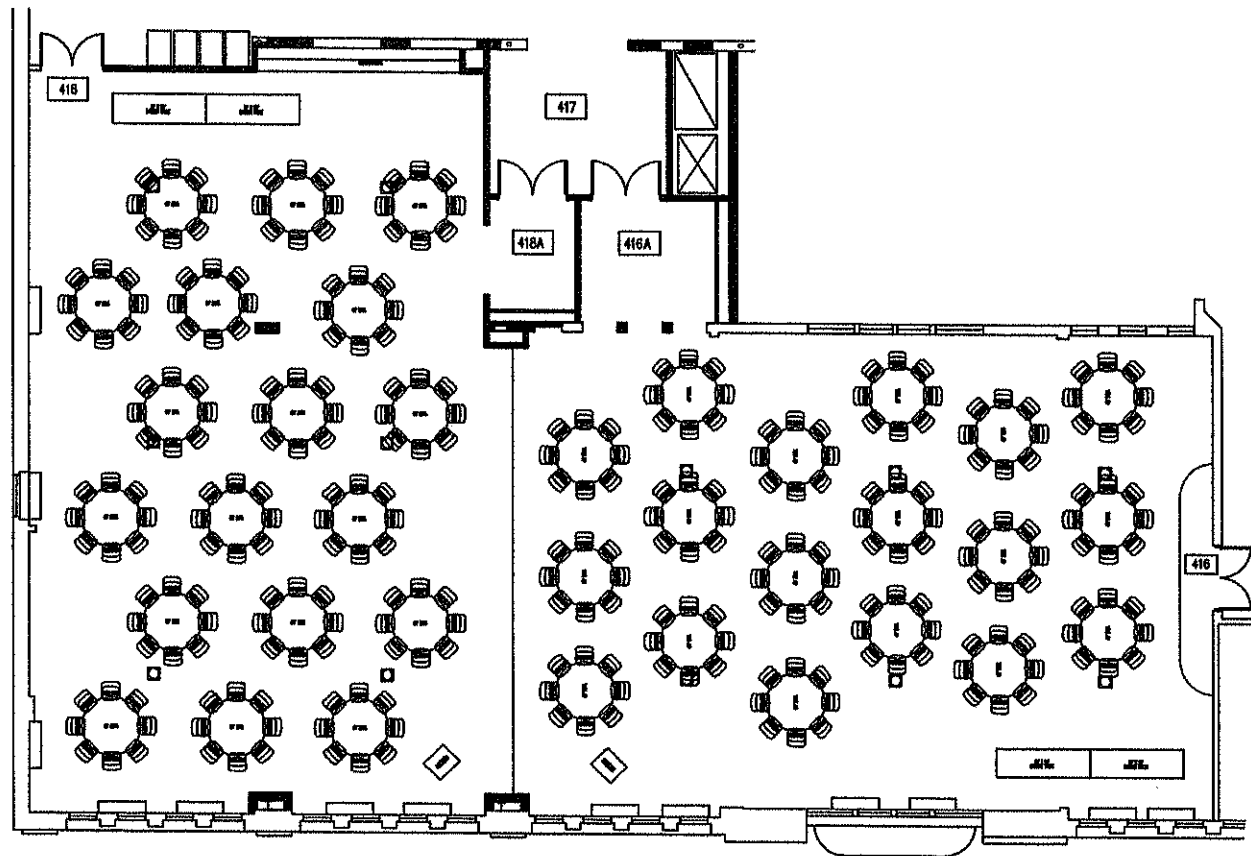

TOTAL OF 60" ROUND TABLES: 18

TOTAL OF 17 1/2" W X 19 3/4" D CHAIRS: 144

TOTAL OF 30" X 96" BANQUET TABLES: 2

TOTAL OF 60" ROUND TABLES: 18

TOTAL OF 17 1/2" W X 19 3/4" D CHAIRS: 144

TOTAL OF 30" X 96" BANQUET TABLES: 2

APPROVED BY: \_\_\_\_\_

**elements IV**  
interiors

3680 Wyse Road, Dayton, OH, 45414  
(937) 918-1000 / Fax (937) 918-1001

88 CEG/CECH, Building 57 Area B  
2130 Monahan Way, WPAFB, OH, 45433  
(937) 252-3982 / Fax (937) 252-5091

www.elementsiv.com

## ORR-STATLER HOTEL RENOVATION

PROPOSAL #: PIQUA01

SCALE: 1/16" = 1'-0"

DATE DRAWN: 3/13/08

DRAWN BY: ANNE SEWELL

SALES PERSON/PROJECT MANAGER: TARA HUCKE

REVISIONS

NO. 1	3/19/08
NO. 2	4/10/08
NO. 3	4/11/08
NO. 4	4/14/08
NO. 5	